

2023 Hampton Falls Tax Maps NH

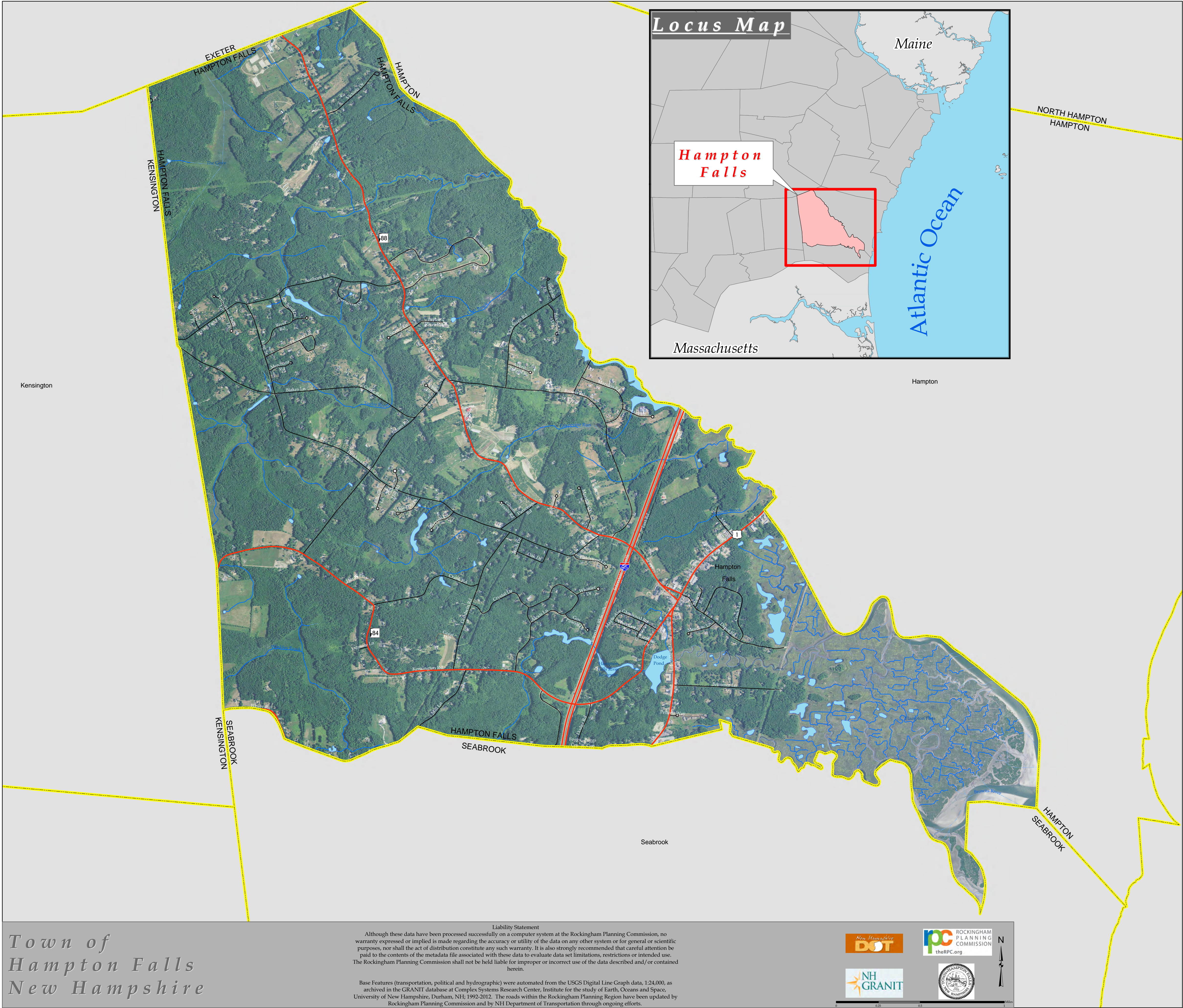

Town of
Hampton Falls
New Hampshire

Liability Statement
Although these data have been processed successfully on a computer system at the Rockingham Planning Commission, no warranty expressed or implied is made regarding the accuracy or utility of the data on any other system or for general or scientific purposes, nor shall the act of distribution constitute any such warranty. It is also strongly recommended that careful attention be paid to the contents of the metadata file associated with these data to evaluate data set limitations, restrictions or intended use. The Rockingham Planning Commission shall not be held liable for improper or incorrect use of the data described and/or contained herein.

Base Features (transportation, political and hydrographic) were automated from the USGS Digital Line Graph data, 1:24,000, as archived in the GRANIT database at Complex Systems Research Center, Institute for the study of Earth, Oceans and Space, University of New Hampshire, Durham, NH; 1992-2012. The roads within the Rockingham Planning Region have been updated by Rockingham Planning Commission and by NH Department of Transportation through ongoing efforts.



*Town of Hampton Falls
Rockingham County
New Hampshire*

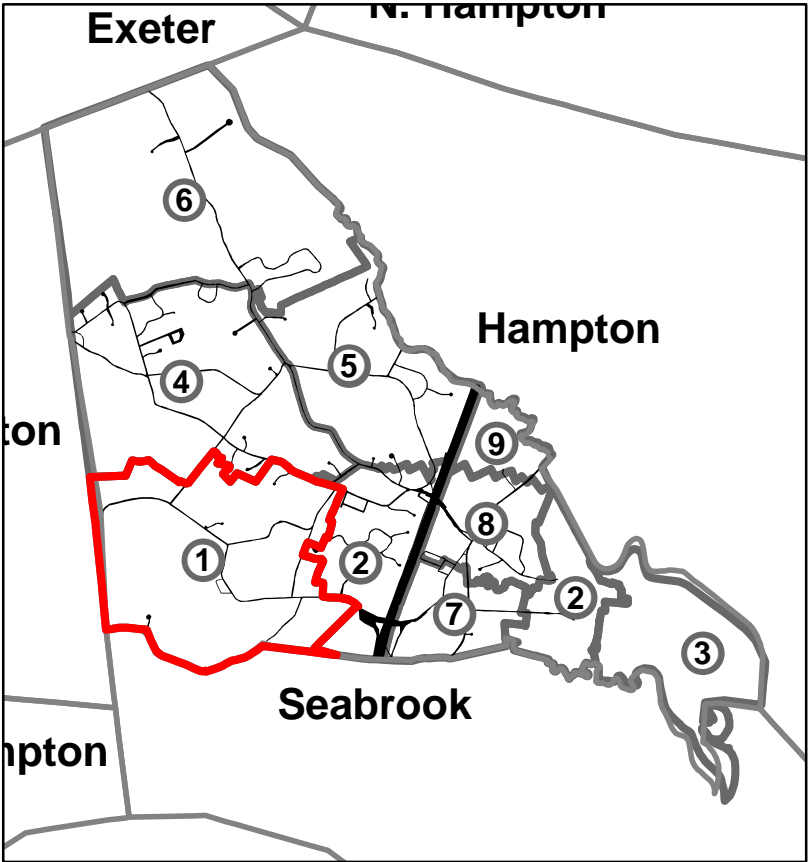

Disclaimer:

This map is for planning purposes only and not to be used for conveyances. All data represented is for planning and is not accurate for site details.

Source:

Property maps were prepared in April 1997 by James W. Sewall Co., Old Town, ME. Conversion to GIS in 2001 by The Rockingham Planning Commission. Subsequent maintenance performed by RPC.

Maps have been updated through May 2023.

Produced by the Rockingham Planning Commission May 2023.



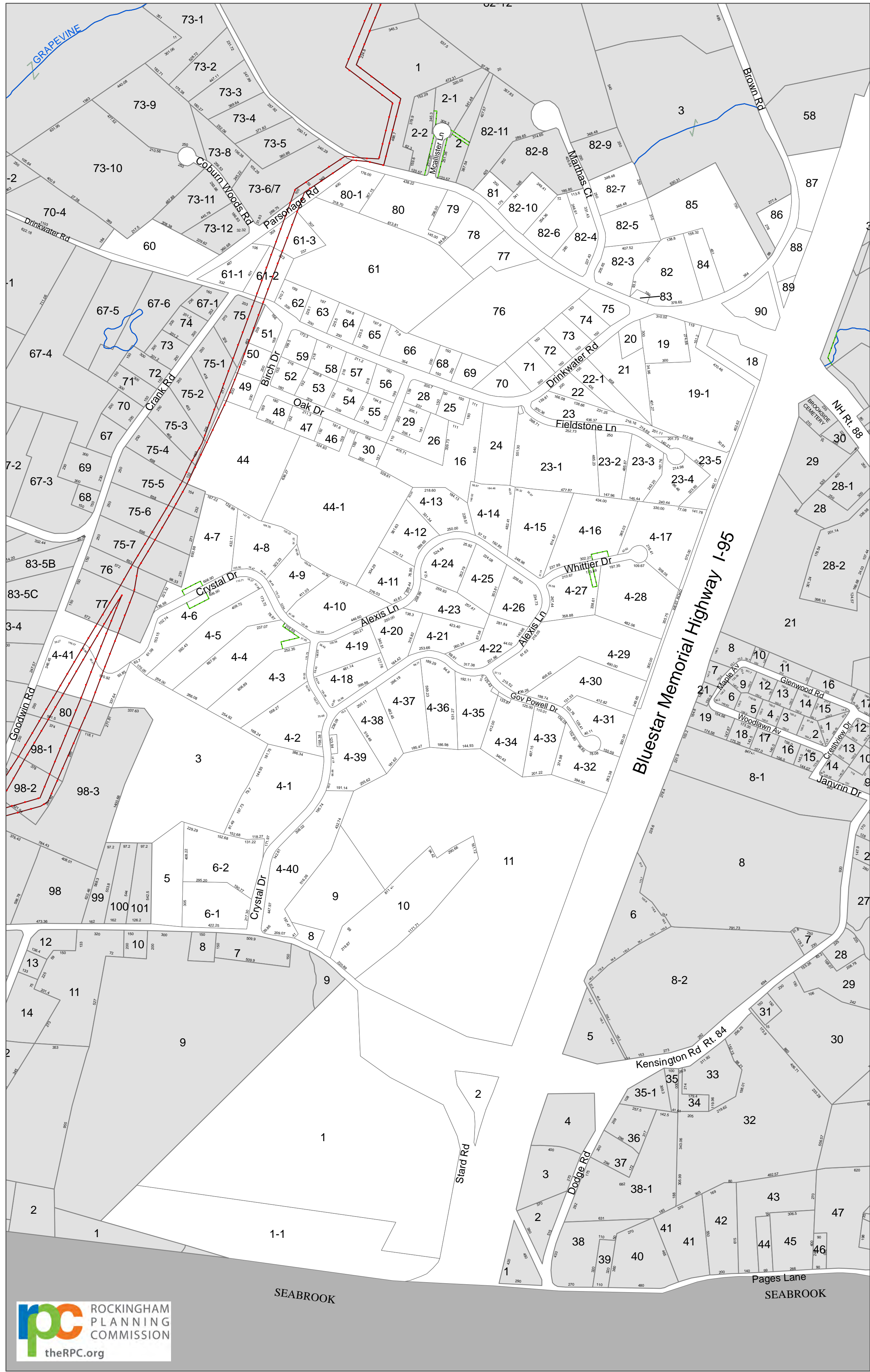

Tax Map

Town of Hampton Falls
Rockingham County
New Hampshire

Other Layers

- Hooks
- Easements
- Utility ROW
- Stream
- From CAD
- Adjacent Maps
- Parcels 2023

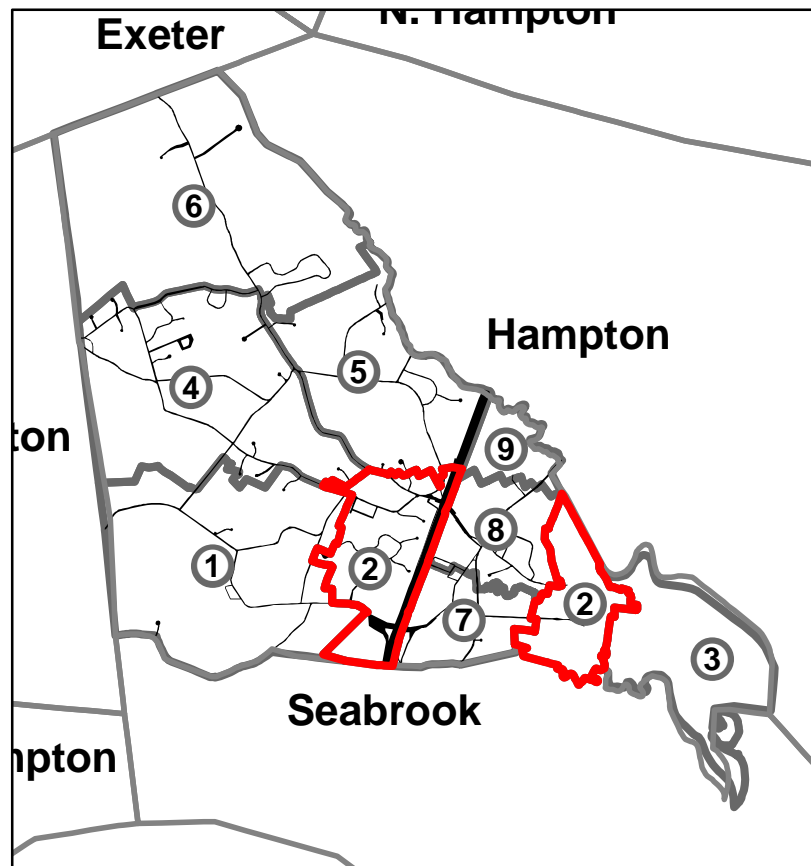

TAX MAP INDEX

Disclaimer:

This map is for planning purposes only and not to be used for conveyances. All data represented is for planning and is not accurate for site details.

Source:

Property maps were prepared in April 1997 by James W. Sewall Co., Old Town, ME. Conversion to GIS in 2001 by The Rockingham Planning Commission. Subsequent maintenance performed by RPC.

Maps have been updated through May 2023.

Produced by the Rockingham Planning Commission May 2023.

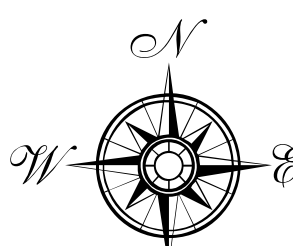

0 0.125 0.25
Miles

Map 2



Tax Map

Town of Hampton Falls
Rockingham County
New Hampshire

Other Layers

- Hooks
- Easements
- Utility ROW
- Stream
- From CAD
- Adjacent Maps
- Parcels 2023

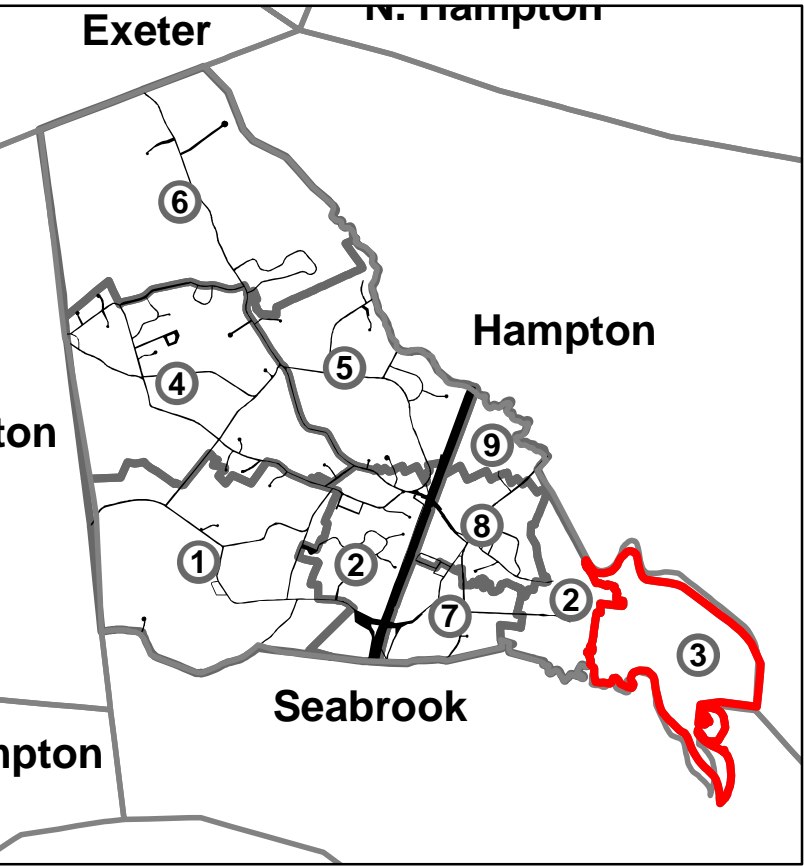

TAX MAP INDEX

Disclaimer:

This map is for planning purposes only and not to be used for conveyances. All data represented is for planning and is not accurate for site details.

Source:

Property maps were prepared in April 1997 by James W. Sewall Co., Old Town, ME. Conversion to GIS in 2001 by The Rockingham Planning Commission. Subsequent maintenance performed by RPC.

Maps have been updated through May 2023.

Produced by the Rockingham Planning Commission May 2023.

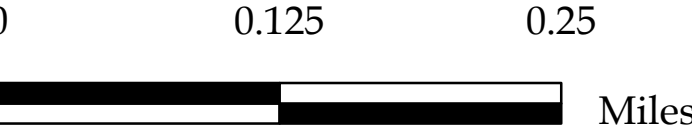
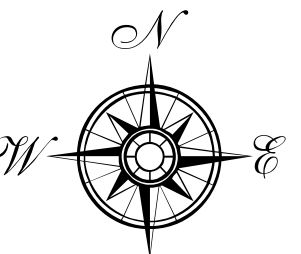

Map 3

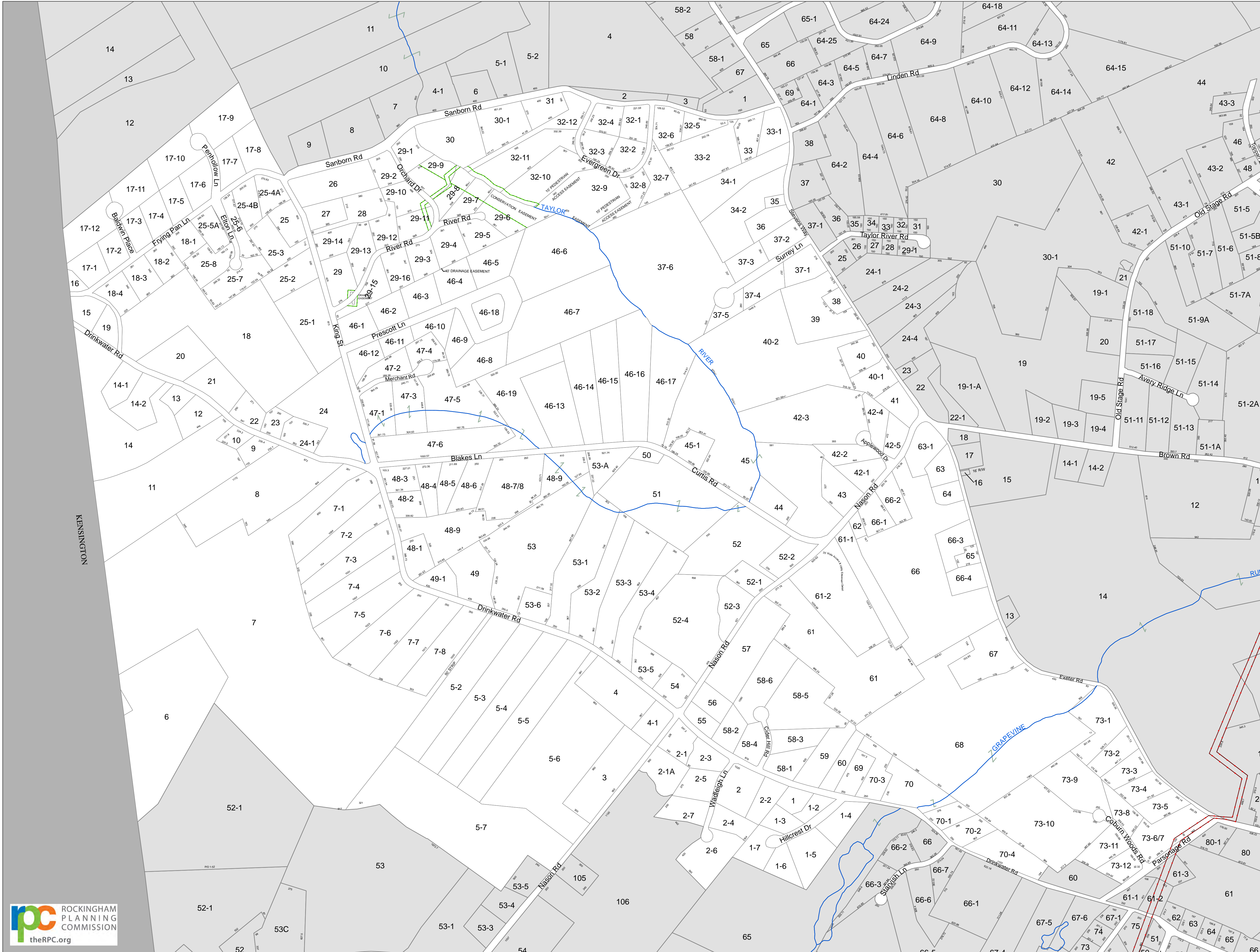

Tax Map

Town of Hampton Falls
Rockingham County
New Hampshire

Other Layers

Layer

- Hooks
- Easements
- Utility ROW
- Stream
- From CAD
- Adjacent Maps
- Parcels 2023

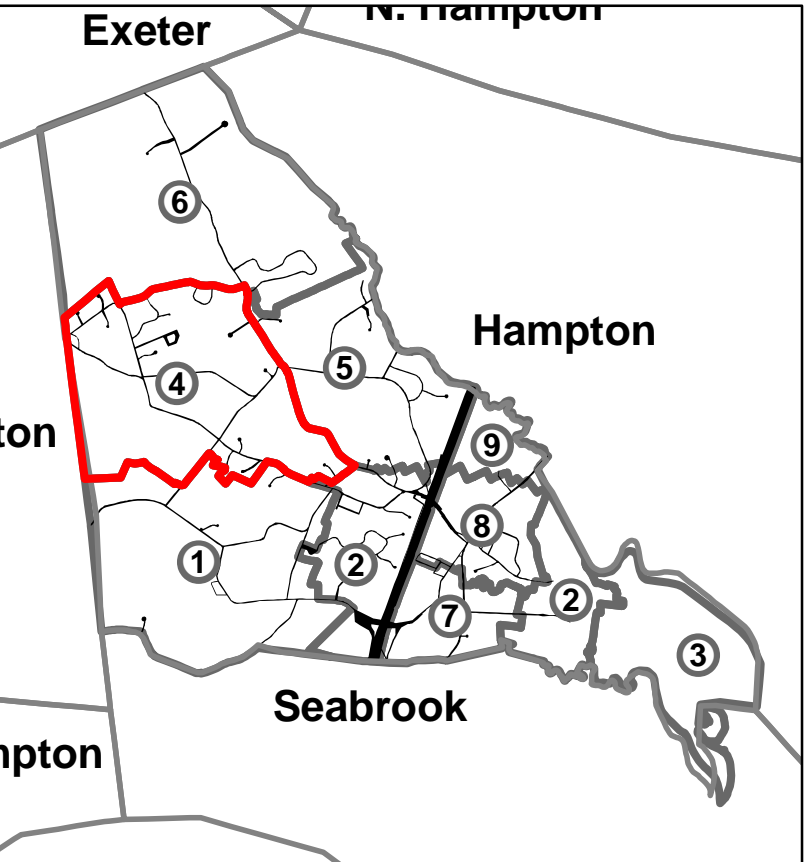

TAX MAP INDEX

Disclaimer:

This map is for planning purposes only and not to be used for conveyances. All data represented is for planning and is not accurate for site details.

Source:

Property maps were prepared in April 1997 by James W. Sewall Co., Old Town, ME. Conversion to GIS in 2001 by The Rockingham Planning Commission. Subsequent maintenance performed by RPC.

Maps have been updated through May 2023.

Produced by the Rockingham Planning Commission May 2023.

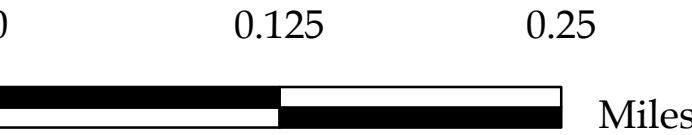
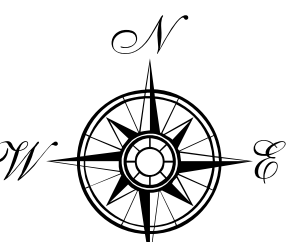

Map 4

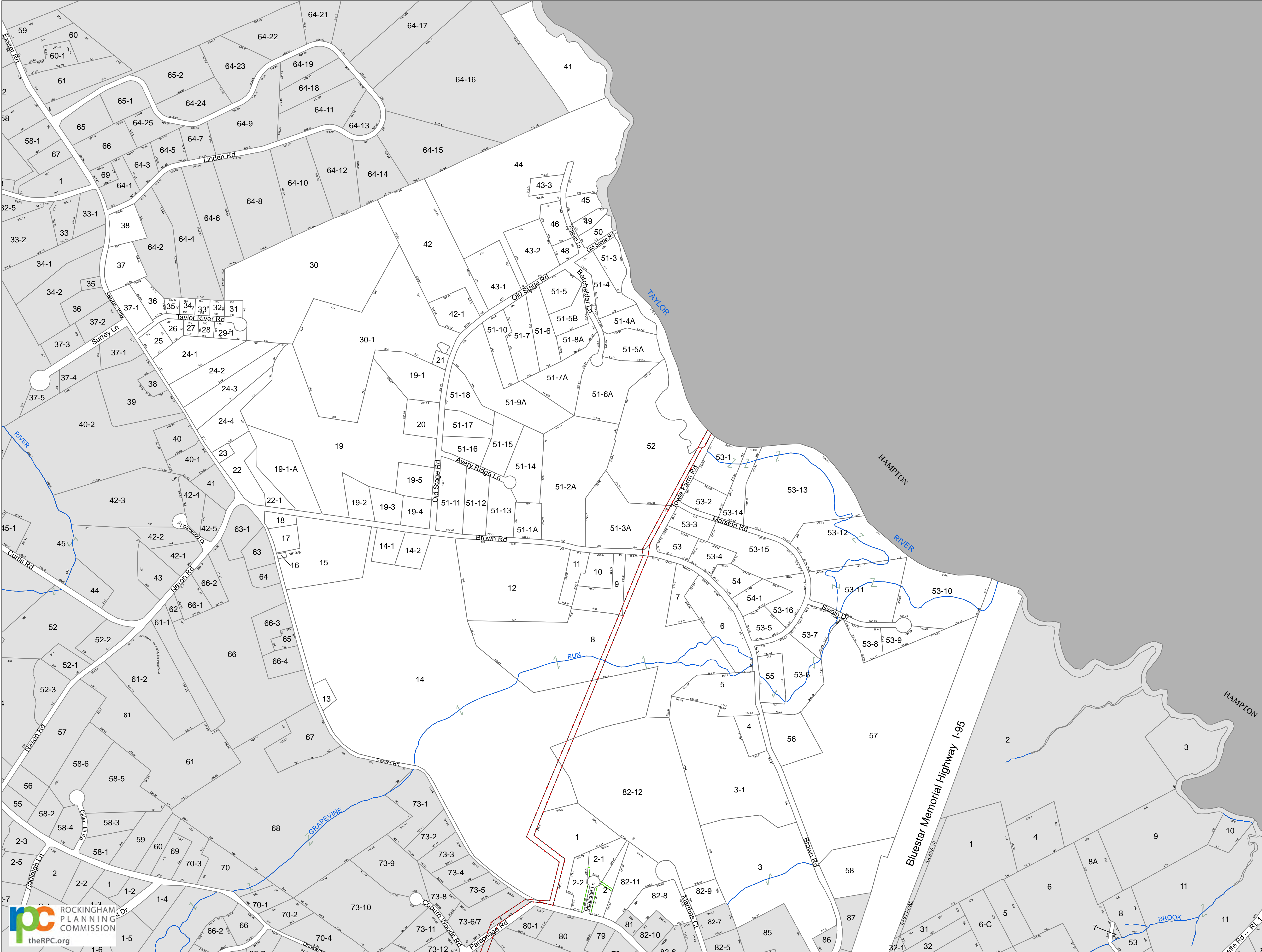

Tax Map

Town of Hampton Falls
Rockingham County
New Hampshire

Other Layers

Layer

- Hooks
- Easements
- Utility ROW
- Stream
- From CAD
- Adjacent Maps
- Parcels 2023

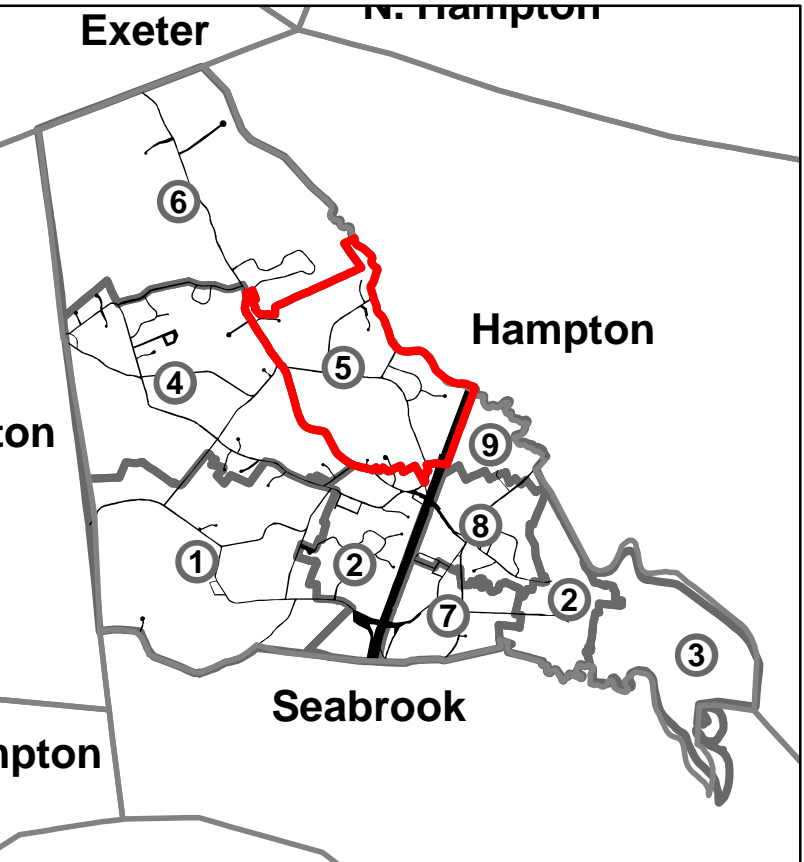

TAX MAP INDEX

Disclaimer:

This map is for planning purposes only and not to be used for conveyances. All data represented is for planning and is not accurate for site details.

Source:

Property maps were prepared in April 1997 by James W. Sewall Co., Old Town, ME. Conversion to GIS in 2001 by The Rockingham Planning Commission. Subsequent maintenance performed by RPC.

Maps have been updated through May 2023.

Produced by the Rockingham Planning Commission May 2023.

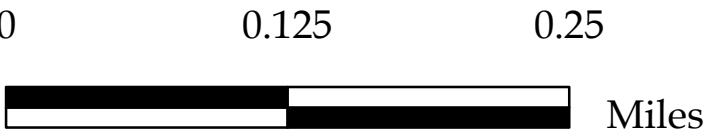
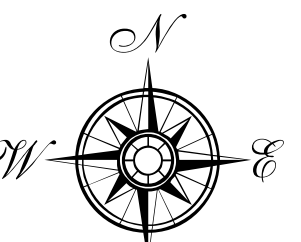

Map 5

Tax Map

Town of Hampton Falls
Rockingham County
New Hampshire

Other Layers

Layer

- Hooks
- Easements
- Utility ROW
- Stream
- From CAD
- Adjacent Maps
- 2023 Parcels

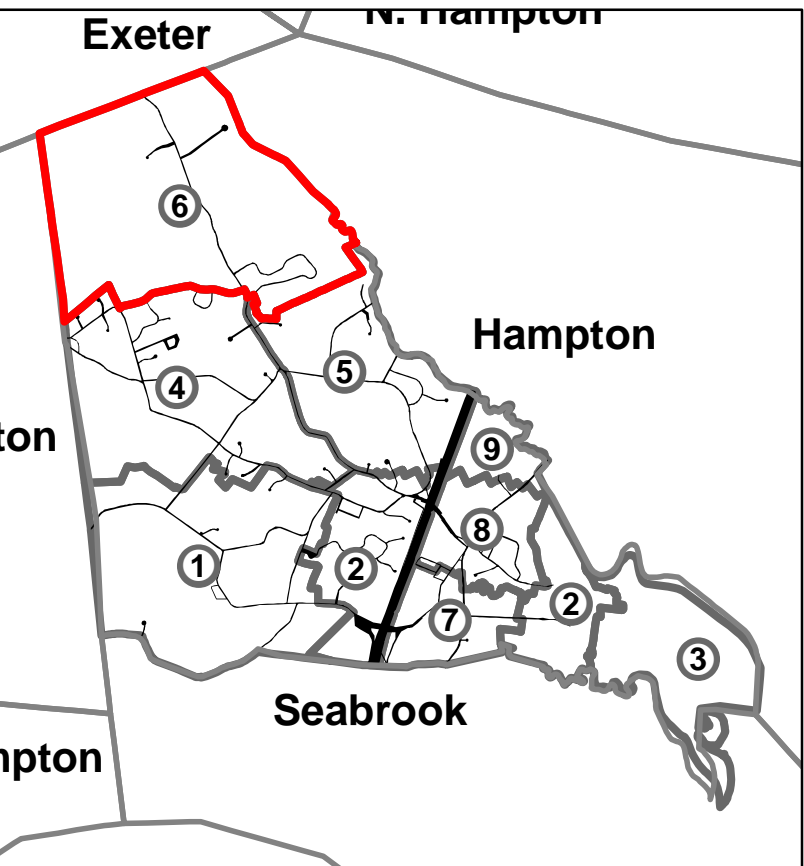

TAX MAP INDEX

Disclaimer:

This map is for planning purposes only and not to be used for conveyances. All data represented is for planning and is not accurate for site details.

Source:
Property maps were prepared in April 1997 by James W. Sewall Co., Old Town, ME. Conversion to GIS in 2001 by The Rockingham Planning Commission. Subsequent maintenance performed by RPC.

Maps have been updated through May 2023.

Produced by the Rockingham Planning Commission May 2023.

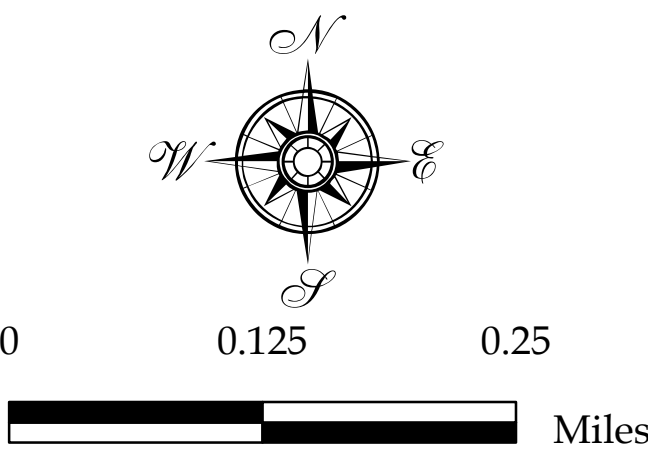

Map 6

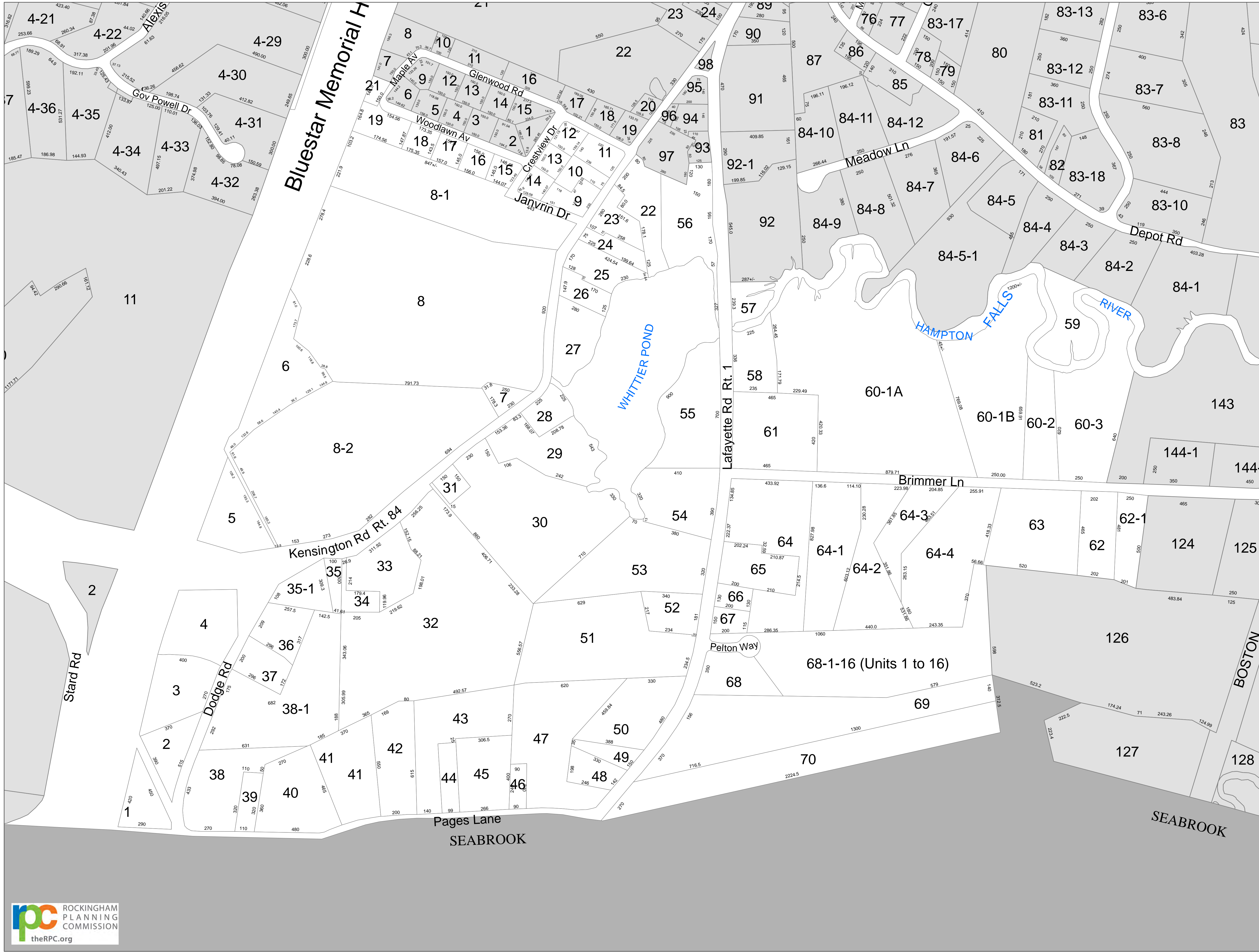

Tax Map

Town of Hampton Falls
Rockingham County
New Hampshire

Other Layers

Layer

- Hooks
- Easements
- Utility ROW
- Stream
- From CAD
- Adjacent Maps
- Parcels 2023

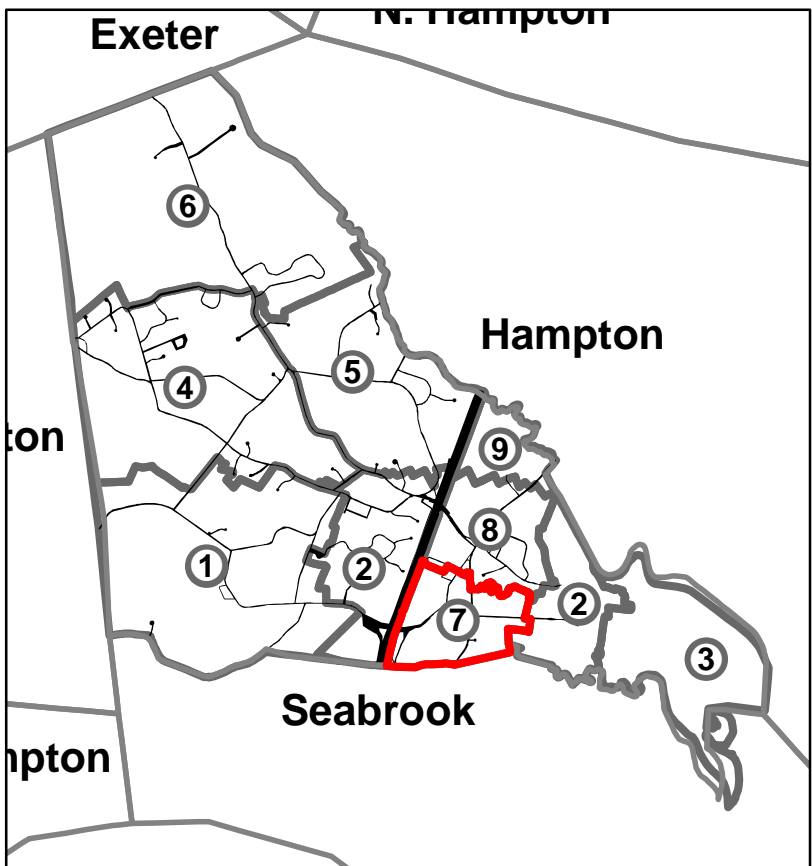

TAX MAP INDEX

Disclaimer:

This map is for planning purposes only and not to be used for conveyances. All data represented is for planning and is not accurate for site details.

Source:
Property maps were prepared in April 1997 by James W. Sewall Co., Old Town, ME. Conversion to GIS in 2001 by The Rockingham Planning Commission. Subsequent maintenance performed by RPC.

Maps have been updated through May 2023.

Produced by the Rockingham Planning Commission May 2023.

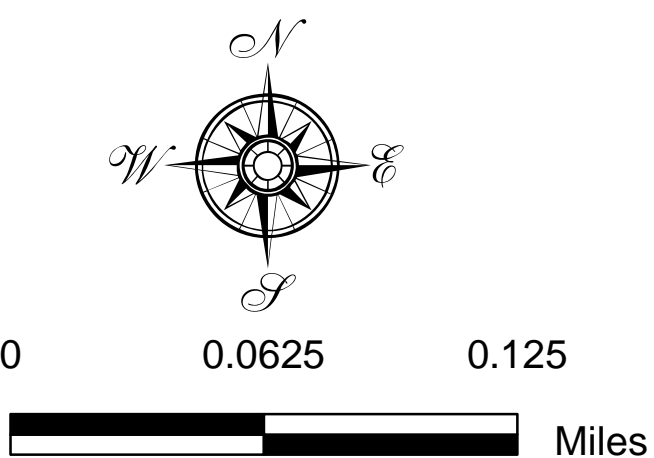

Map 7

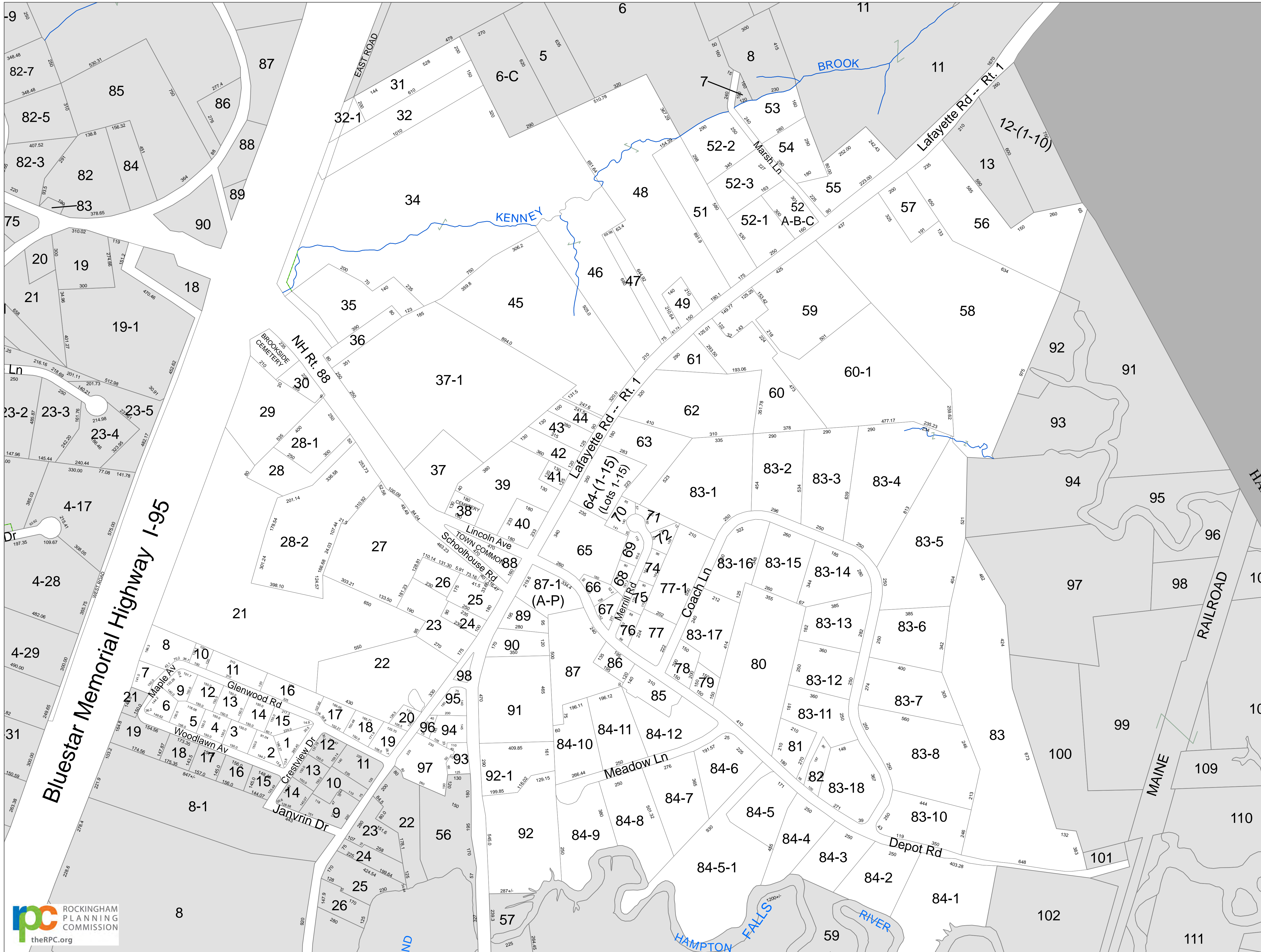

Tax Map

Town of Hampton Falls
Rockingham County
New Hampshire

Other Layers

Layer

- Hooks
- Easements
- Utility ROW
- Stream
- From CAD
- Adjacent Maps
- Parcels 2023

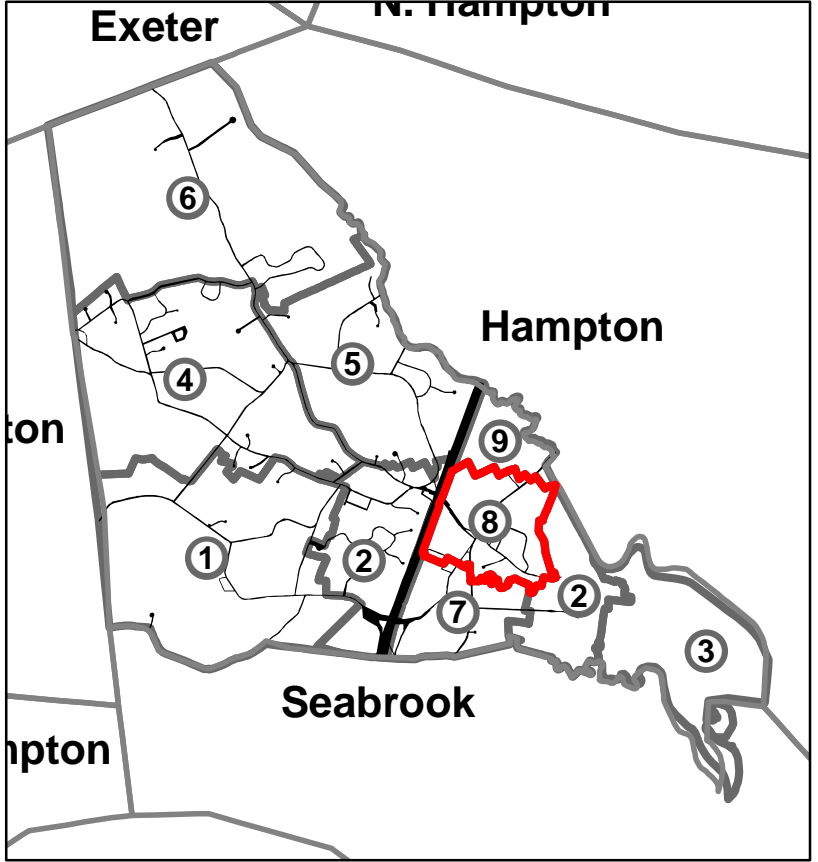

TAX MAP INDEX

Disclaimer:

This map is for planning purposes only and not to be used for conveyances. All data represented is for planning and is not accurate for site details.

Source:

Property maps were prepared in April 1997 by James W. Sewall Co., Old Town, ME. Conversion to GIS in 2001 by The Rockingham Planning Commission. Subsequent maintenance performed by RPC.

Maps have been updated through May 2023.

Produced by the Rockingham Planning Commission May 2023.

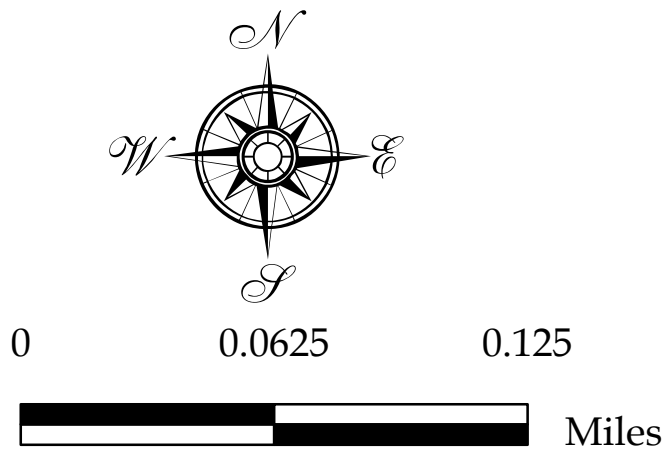

Map 8



Tax Map

Town of Hampton Falls
Rockingham County
New Hampshire

Other Layers

Layer

- Hooks
- Easements
- Utility ROW
- Stream
- From CAD
- Adjacent Maps
- Parcels 2023

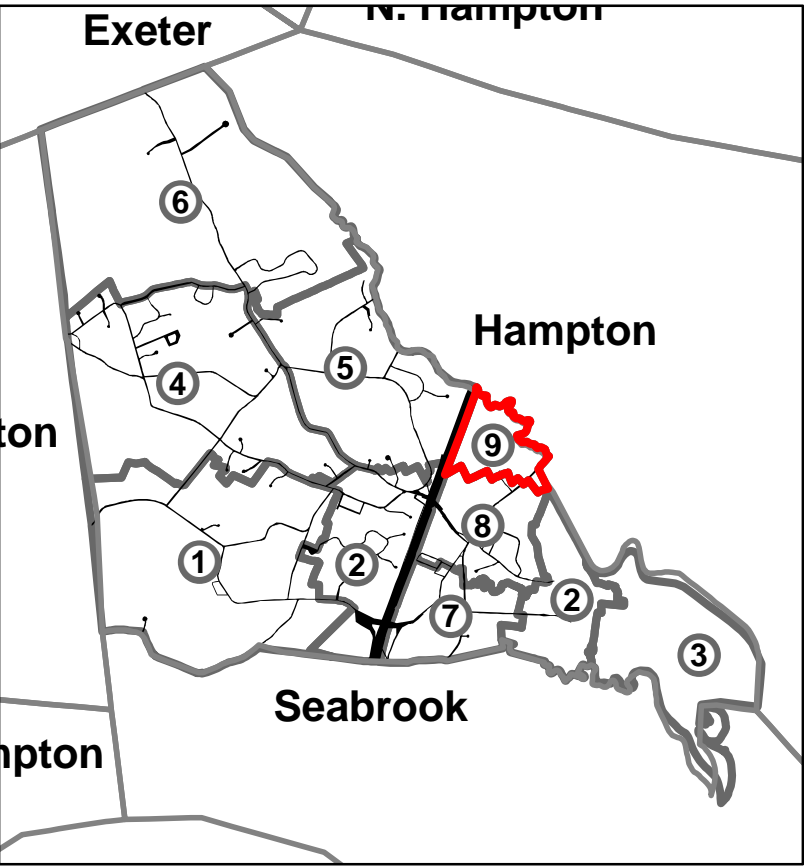

TAX MAP INDEX

Disclaimer:

This map is for planning purposes only and not to be used for conveyances. All data represented is for planning and is not accurate for site details.

Source:

Property maps were prepared in April 1997 by James W. Sewall Co., Old Town, ME. Conversion to GIS in 2001 by The Rockingham Planning Commission. Subsequent maintenance performed by RPC.

Maps have been updated through May 2023.

Produced by the Rockingham Planning Commission May 2023.

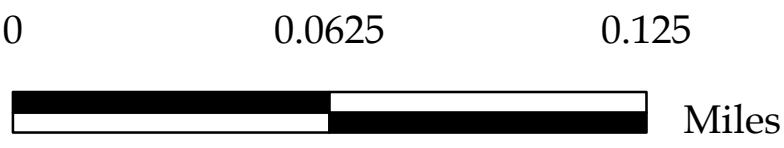
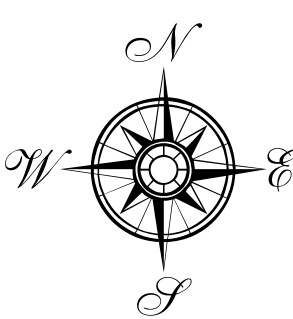

Map 9

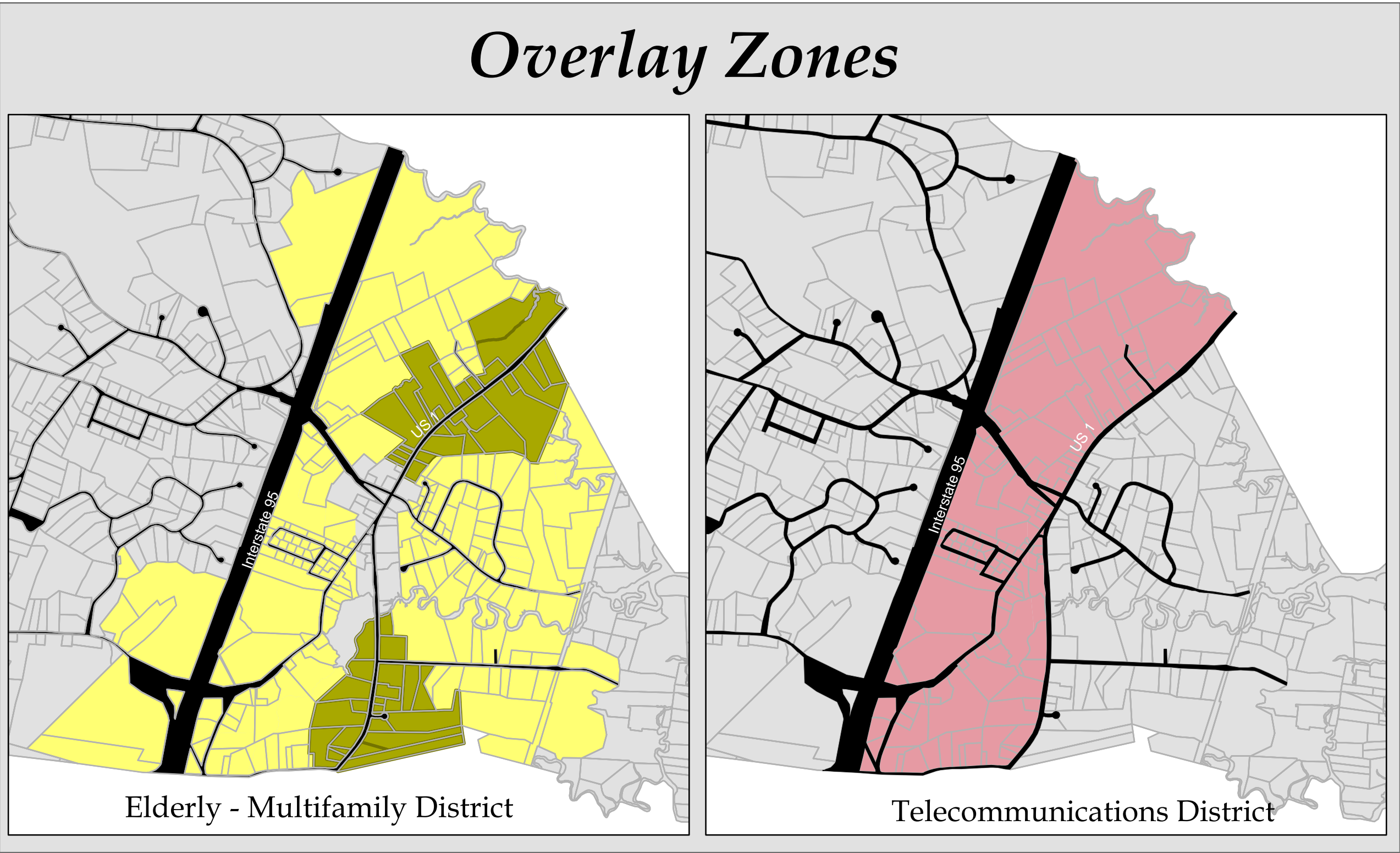
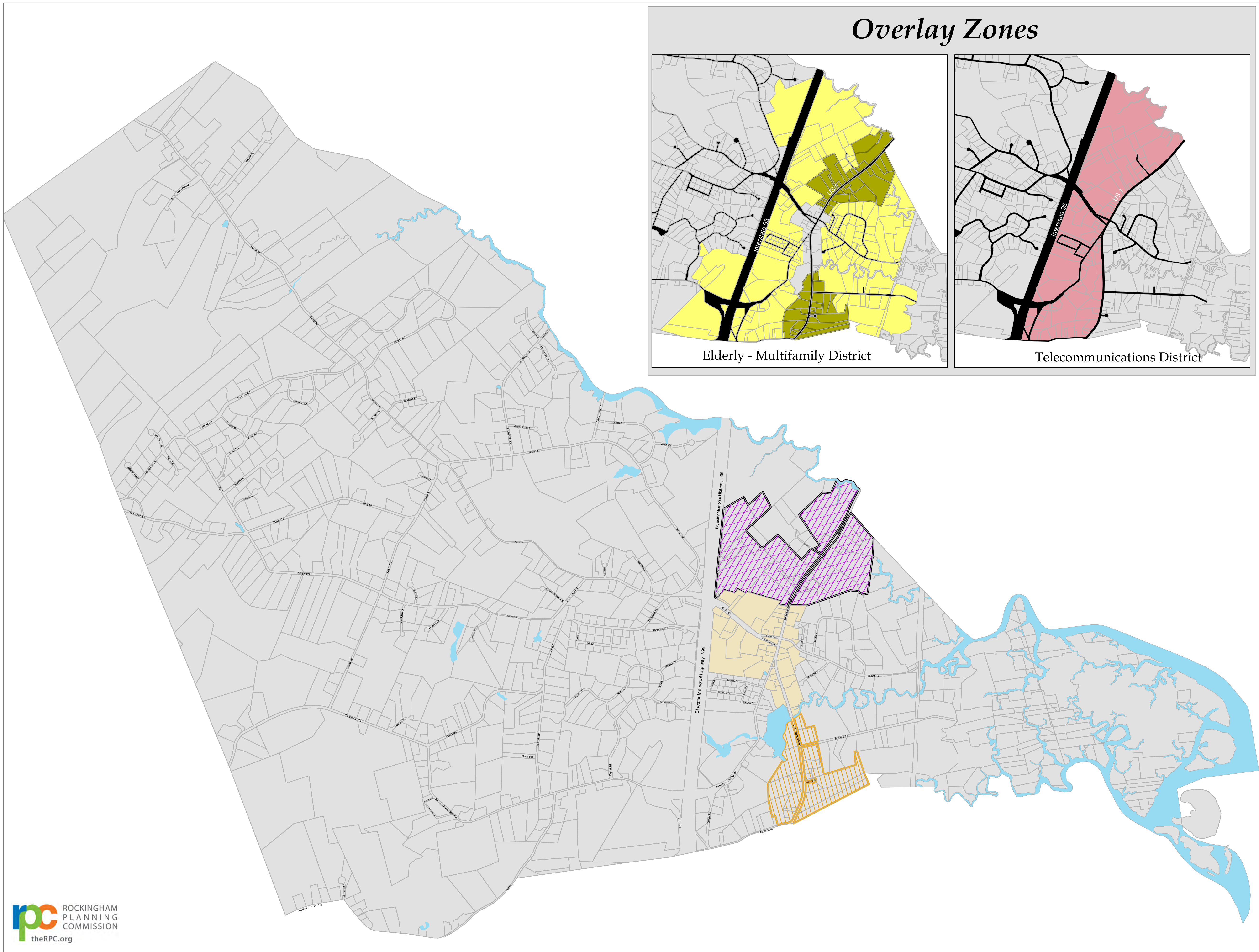

Tax Map

Town of Hampton Falls
Rockingham County
New Hampshire

Adopted Zoning (2014)

- Zone**
- Agricultural/Residential
 - Business District North
 - Business District South
 - Town Common District
 - Telecommunications District
 - Elderly-MultiFamily
 - Multifamily
 - Road

This map is the understood zoning at the date of the map. This map is an unofficial representation of the official zoning map. Regardless of the existence of other printed copies of the Zoning Map, the Official Zoning Map shall be located in the Town office. For any discrepancies, please refer to the zoning ordinance which shall be the final authority as to the current zoning status of the land and water areas, buildings, and other structures in the town. The RPC does not redistribute this map to anyone but town officials and makes no claim about the accuracy of the data reflected here.

Disclaimer:

This map is for planning purposes only and not to be used for conveyances. All data represented is for planning and is not accurate for site details.

Source:
Property maps were prepared in April 1997 by James W. Sewall Co., Old Town, ME. Conversion to GIS in 2001 by The Rockingham Planning Commission. Subsequent maintenance performed by RPC.

Maps have been updated through May 2023.

Produced by the Rockingham Planning Commission May 2023.

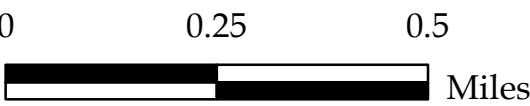

Zoning

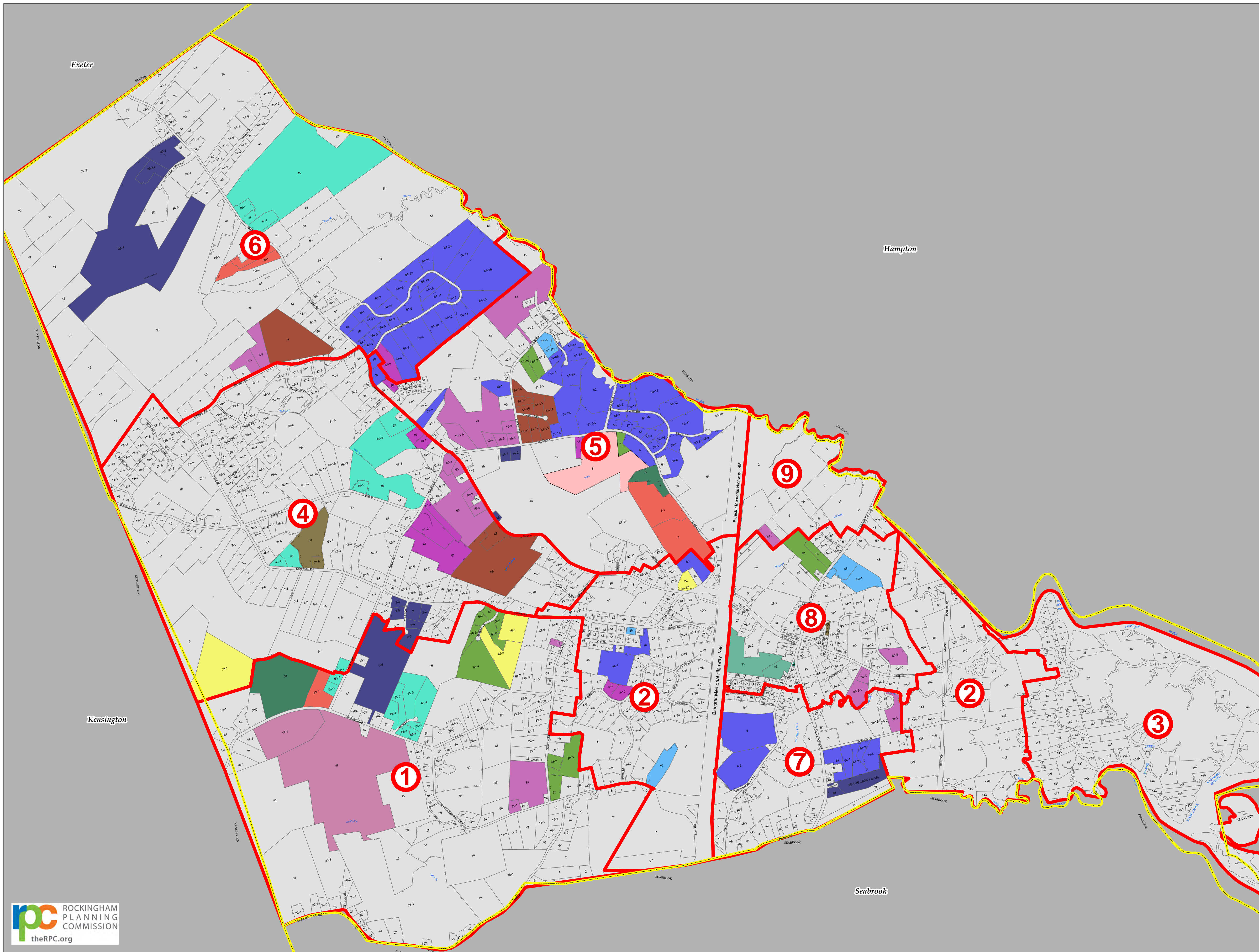

Tax Map

Town of Hampton Falls
Rockingham County
New Hampshire

Map Extents

Year Updated

- Pre - 1997
- 2001
- 2003
- 2004
- 2005
- 2006
- 2007
- 2008
- 2009
- 2011
- 2012
- 2013
- 2014
- 2016
- 2018
- 2023

Disclaimer:

This map is for planning purposes only and not to be used for conveyances. All data represented is for planning and is not accurate for site details.

Source:

Property maps were prepared in April 1997 by James W. Sewall Co., Old Town, ME. Conversion to GIS in 2001 by The Rockingham Planning Commission. Subsequent maintenance performed by RPC.

Maps have been updated through May 2023.

Produced by the Rockingham Planning Commission May 2023.

0 0.25 0.5
Miles



Composite